



Ordnance Survey, (c) Crown Copyright 2019. All rights reserved. Licence number 100022432

ALL DIMENSIONS ARE TO BE VERIFIED ON SITE, BEFORE CONSTRUCTION AND ORDERING OF MATERIALS. PLEASE CONTACT THE ARCHITECT FOR CLARIFICATION ON DISCREPANCIES - DO NOT ASSUME.

REVISIONS

| Rev | Date | Description | Sig |
|-----|------|-------------|-----|
| | | | |
| | | | |
| | | | |
| | | | |
| | | | |
| | | | |
| | | | |
| | | | |
| | | | |

Vagdia and Holmes

CHARTERED ARCHITECTS

The Architect's Studio,
12a Coventry Canal Basin,
St. Nicholas Street, Coventry, CV1 4LY

(t) 024 7622 2393 (e) info@vagdiaholmes.com

Project: Proposed Driveway at
Ivy Farm House,
Ivy Farm Lane,
Coventry,
CV4 7BW

Client: Mr & Mrs Rai

Title: Location Plan



Date
Drawn by
Checked by
Scale
Nov 2022
JLB
DV
1:1250 @ A4

Drawing Number

1865-LP-001

For: LOCATION PLAN

This drawing is copyright © to Vagdia & Holmes Limited 2022. All Rights Reserved
This drawing is the property of Vagdia & Holmes Limited, it must not be copied or reproduced or divulged to anyone without written permission.

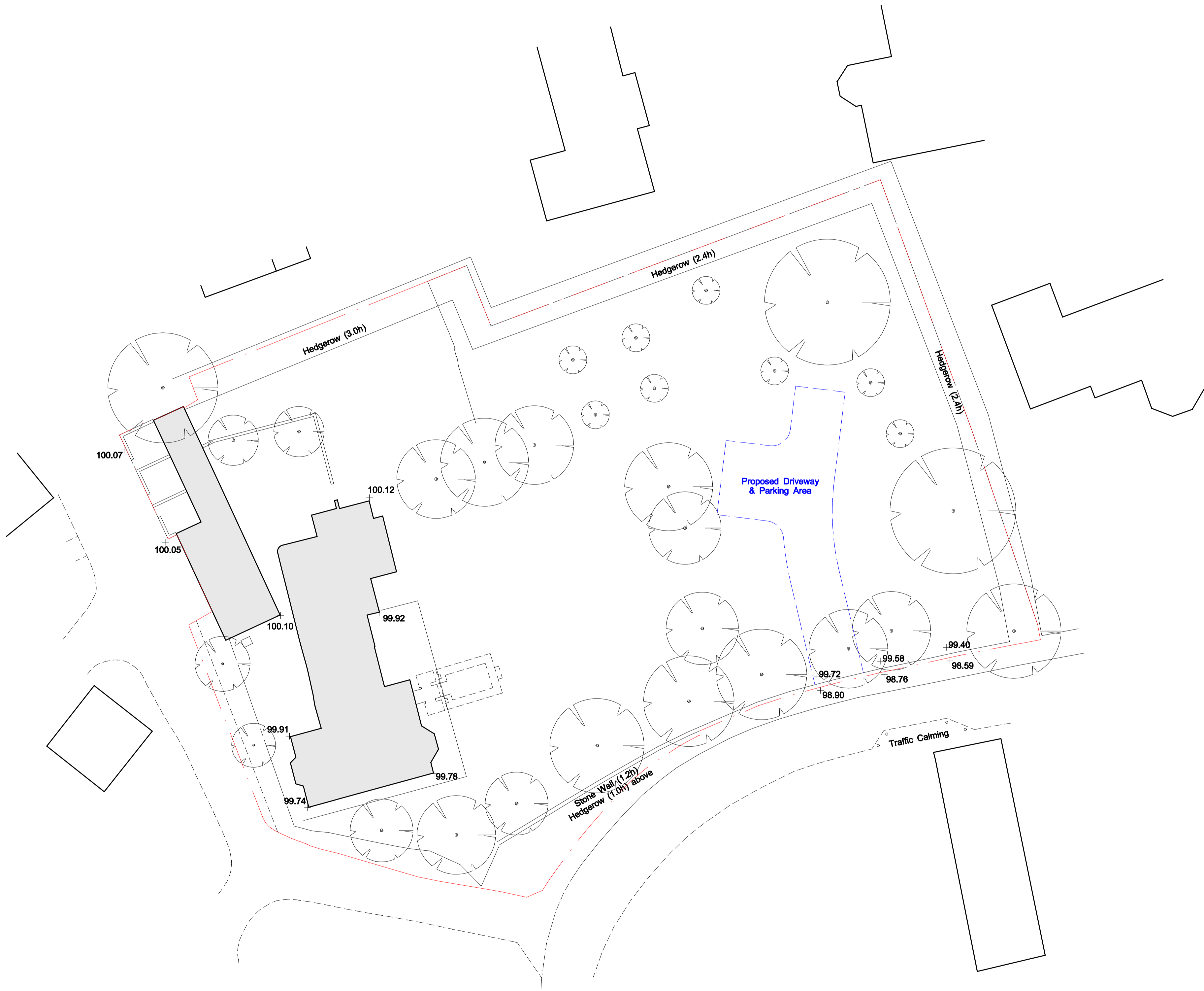

ALL DIMENSIONS ARE TO BE VERIFIED ON SITE, BEFORE CONSTRUCTION AND ORDERING OF MATERIALS. PLEASE CONTACT THE ARCHITECT FOR CLARIFICATION ON DISCREPANCIES - DO NOT ASSUME.

| REVISIONS | | | |
|-----------|------|-------------|-----|
| Rev | Date | Description | Sig |
| | | | |
| | | | |
| | | | |
| | | | |
| | | | |
| | | | |
| | | | |
| | | | |
| | | | |

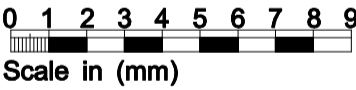

Vagdia and Holmes

CHARTERED ARCHITECTS
The Architect's Studio,
12a Coventry Canal Basin,
St Nicholas Street, Coventry, CV1 4LY
(t) 024 7622 2393 (e) info@vagdiaholmes.com

Project: Proposed Driveway at
Ivy Farm House,
Ivy Farm Lane,
Coventry,
CV4 7BW
Client: Mr & Mrs Rai
Title: Proposed Site / Block Plan

Date: Dec 2022
Drawn by: JLB
Checked by: DV
Scale: 1:200 @ A1
Drawing Number

1865-SP-002

For: PLANNING APPLICATION

This drawing is copyright © to Vagdia & Holmes Limited 2022. All Rights Reserved
This drawing is the property of Vagdia & Holmes Limited. It must not be copied or reproduced or divulged to anyone without written permission.

ALL DIMENSIONS ARE TO BE VERIFIED ON SITE, BEFORE CONSTRUCTION AND ORDERING OF MATERIALS. PLEASE CONTACT THE ARCHITECT FOR CLARIFICATION ON DISCREPANCIES - DO NOT ASSUME.

REVISIONS

| Rev | Date | Description | Slg |
|-----|------|-------------|-----|
| | | | |
| | | | |
| | | | |
| | | | |
| | | | |
| | | | |
| | | | |
| | | | |
| | | | |
| | | | |

- Key
- ① Remove Horse Chestnut Tree ref: T18 (diseased tree)
 - ② Maintain / trim Sycamore Tree ref: T17
 - ③ Breaking through stone wall to create a new vehicular entrance to 2no. parking spaces.
 - ④ New timber gated entrance on 200 x 200mm timber posts with call point

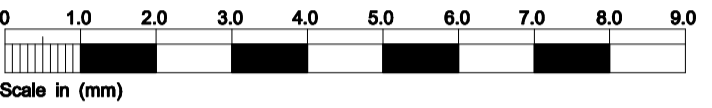

Vagdia and Holmes

CHARTERED ARCHITECTS
The Architects Studio,
12a Coventry Canal Basin,
St. Nicholas Street, Coventry, CV1 4LY
(t) 024 7622 2393 (e) info@vagdiaholmes.com

Project: Proposed Driveway at Ivy Farm House, Ivy Farm Lane, Coventry, CV4 7BW

Client: Mr & Mrs Rai

Title: Proposed Site Plan

Date: Dec 2022
Drawn by: PS
Checked by: DV
Scale: 1:100 @ A1
Drawing Number

1865-SK-004

For: PLANNING APPLICATION

This drawing is copyright © to Vagdia & Holmes Limited 2022. All Rights Reserved
This drawing is the property of Vagdia & Holmes Limited. It must not be copied or reproduced or divulged to anyone without written permission.